

Sill flashing to extend behind line of aluminium frame, with 8mm min upstand to back and sloping end dams. Refer to Figure 72A of E2/AS1 Sill flashing to extend under jamb battens at each end

Window frame (refer to window manufacturer for method of support and fixing)

Frame block supplied by joinery manufacturer to support joinery unit

Edge of Sheet and vertical section under window flange to be sealed before window is installed.

For flashing tape detail refer to Figures 72 and 115 of NZBC clause E2/AS1.

Window liner

Waterproof airseal to perimeter of trim cavity with expandable foam or sealant as per section 9.1.6 of E2/AS1

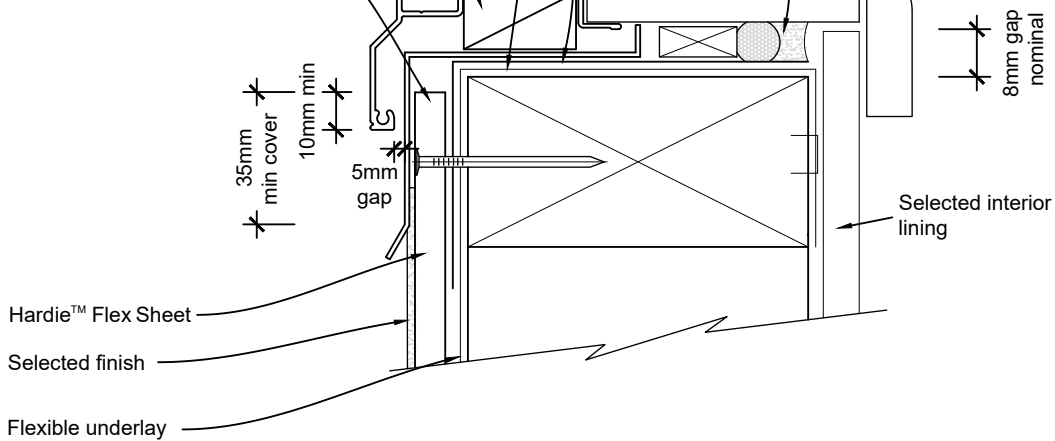

**General notes for materials selection**

1. Flashing materials must be selected based on environmental exposure, refer to NZS 3604 and Table 20 of NZBC E2/AS1.
2. Flexible underlay must comply with acceptable solution E2/AS1 and NZS 3604.
3. Flashing tape must have proven compatibility with the selected flexible underlay and other materials with which it comes into contact as per Table 21 of E2/AS1.

*Refer to the manufacturer or supplier for technical information for these materials.*